

Sidecar

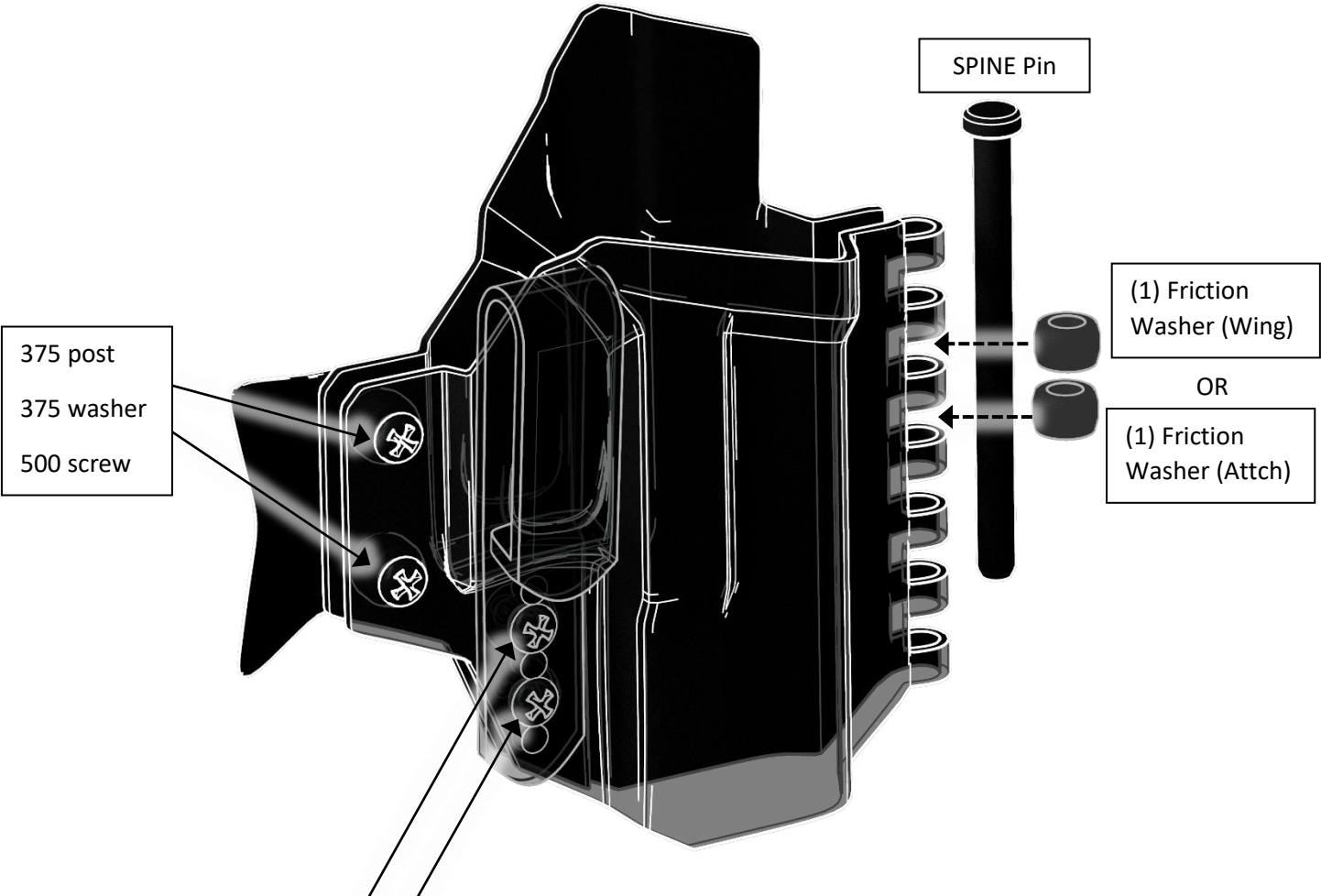

No-Light	W/ Light <i>Plastic</i>	W/ Light <i>Metal</i>
500 post	250 post	250 post
375 washer (inside)	188 washer	188 washer
250 washer (outside)	375 screw	250 screw
625 screw		

Clip Placement

Holsters w/ 2 holes: **top** holes of the clip

Holsters w/ 3 holes: **middle** holes of the clip

Pistol/SD Mag Attachment

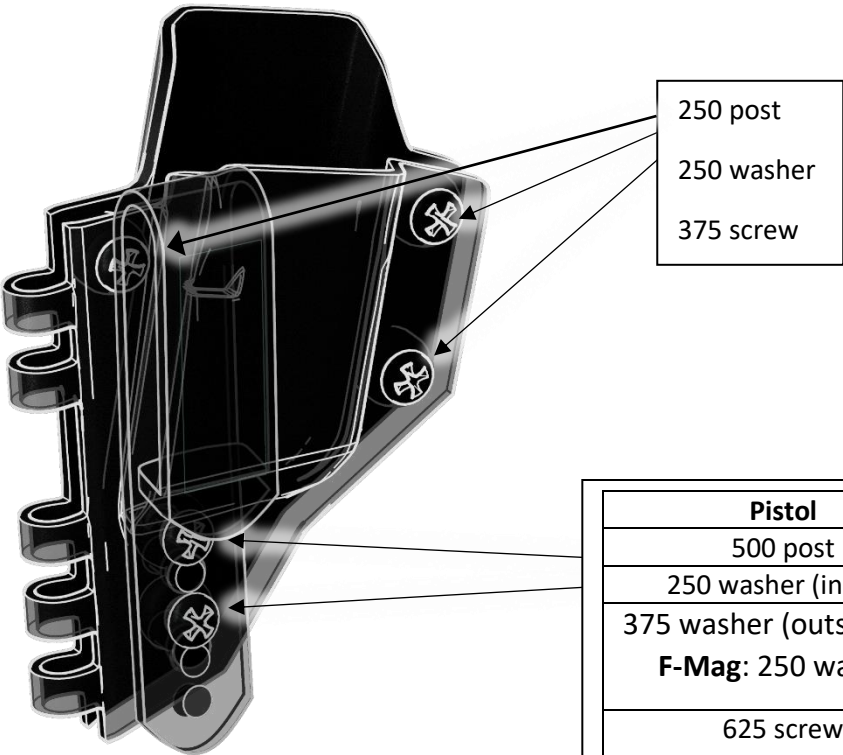

Pistol	SD Plastic	SD Metal
500 post	250 post	250 post
250 washer (inside)	188 washer	188 washer
375 washer (outside) OR F-Mag: 250 washer	375 screw	250 screw
625 screw		

Bottom attachment holes

Top clip holes

Attachment Priority
Pistol Mag Attachment
Tourniquet (TQ) Attachment
Rifle Mag Attachment
SD Attachment
MP5 Attachment
SCP Attachment
MPX Attachment
Cuff Attachment
Raptor Wing

Cuff Attachment

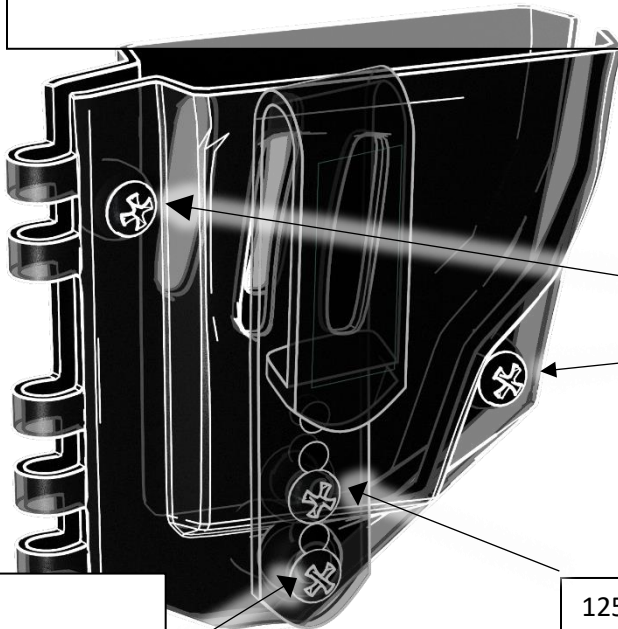

500 post
125 washer
Magnet
125 washer
250 washer (outside)
625 screw

125 post
250 screw
Bottom clip holes

250 post
250 washer
375 screw

Raptor Wing

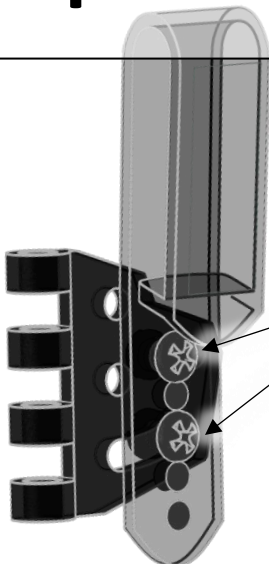

250 post
125 washer
250 screw
Wing outside holes/
Clip top holes

Attachment Priority
Pistol Mag Attachment
Tourniquet (TQ) Attachment
Rifle Mag Attachment
SD Attachment
MP5 Attachment
SCP Attachment
MPX Attachment
Cuff Attachment
Raptor Wing

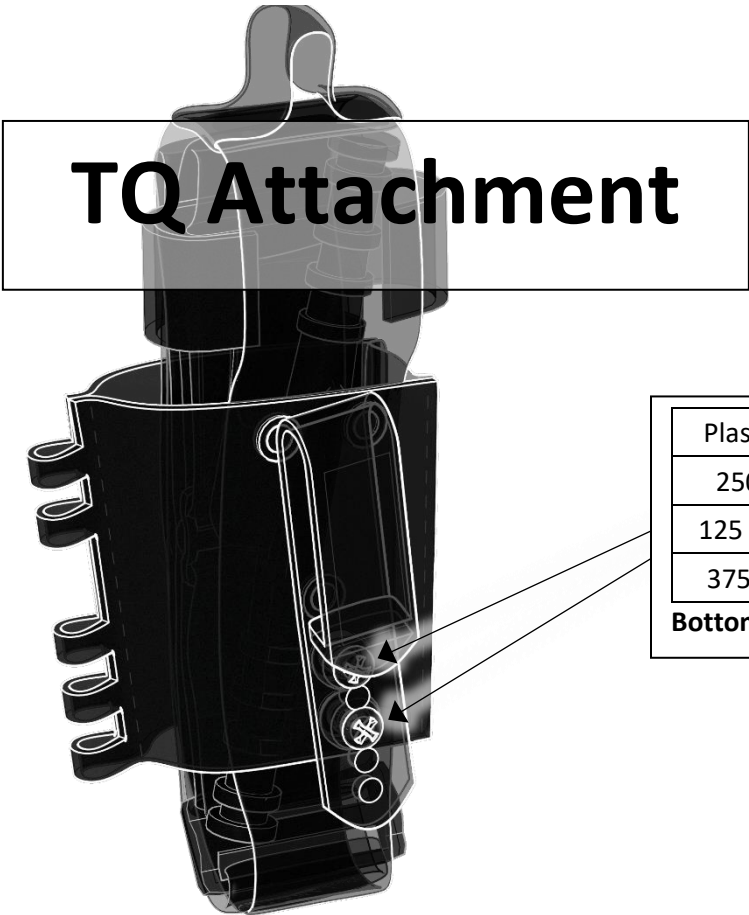

Plastic Clip	Metal Clip
250 post	250 post
125 washer	125 washer
375 screw	250 screw

Bottom attachment/ top clip

Attachment Priority
Pistol Mag Attachment
Tourniquet (TQ) Attachment
Rifle Mag Attachment
SD Attachment
MP5 Attachment
SCP Attachment
MPX Attachment
Cuff Attachment
Raptor Wing

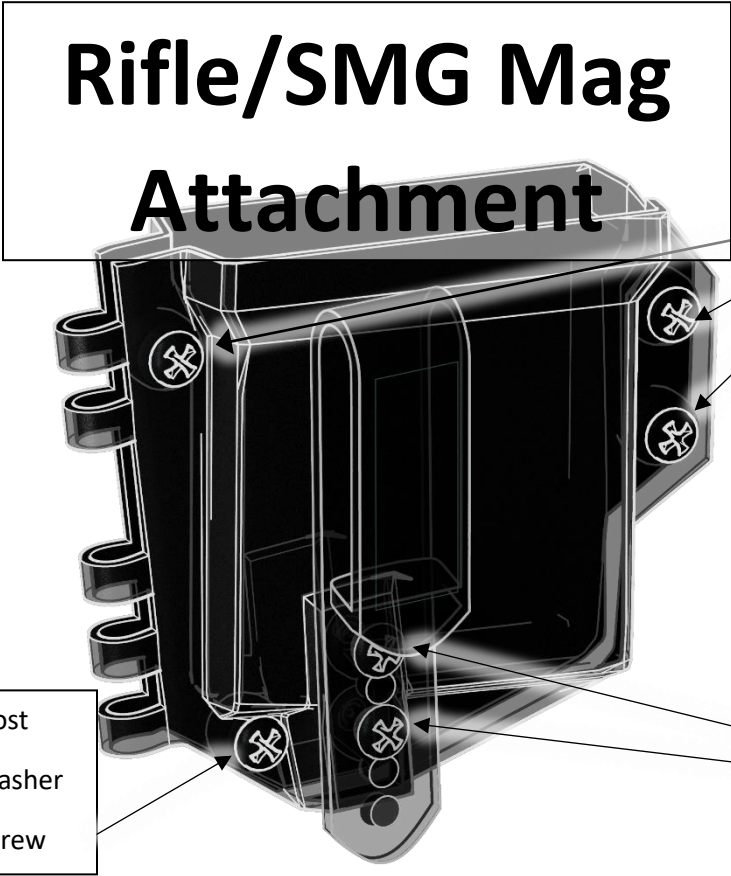

Rifle/SMG Mag Attachment

250 post
250 washer
375 screw

250 post
250 washer
375 screw

Plastic Clip	Metal Clip
250 post	250 post
188 washer	188 washer
375 screw	250 screw

Rifle: bottom attachment holes

MP5/MPX/SCP: middle attachment holes

Middle clip holes